

# architectural BRONZE CASEMENTS

## BRONZE SINGLE CLAD DOOR DATA SHEET

Externally Clad doors are designed with a bead detail to complement our Advanced casements, whilst providing a softer timber finish to match your interior. Available as french doors or single openers, the clad door system provides improved thermal performance over our Solid Bronze doors. Primarily for use as an exterior door, a substantial frame, bronzed ironmongery and multipoint locking options offer good levels of security and an imposing entrance to your property.

SECTION THROUGH BRONZE SINGLE CLAD DOOR SYSTEM

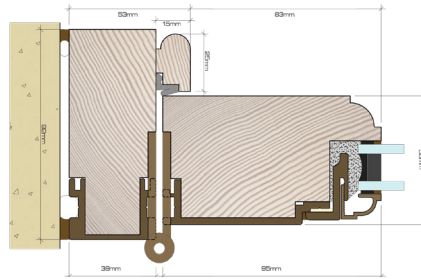

### DIMENSIONS

Frame depth	92mm
Sightline (internal)	136mm

### FEATURES

Outward opening.  
Internal timberwork available in a variety of colours and stains.

### RECOMMENDED DESIGN LIMITS

Single Door	Max O/A width	935mm (850mm Door leaf)
	Min O/A width	685mm (600mm Door leaf)
	Max O/A height	2382mm (2300mm Door leaf)
Double doors	Max O/A width	1792mm (850mm Door leaf)
	Min O/A width	1092mm (500mm Door leaf)
	Max O/A height	2382mm (2300mm Door leaf)

The inclusion of glazing bars, opaque glazing and/or abutment details may alter performance data and design limits. Please contact our sales team to discuss any requirements outside of the standard size limits detailed above.

### U-VALUE

(Pending ratification)

U-value performance based on an 18mm sealed double glazed unit made up of 4mm tough/10mm 90% Krypton filled cavity/4mm tough Planitherm total + with warm edge spacer:

Single door overall value	1.7W/m <sup>2</sup> K
Double door overall value	2.4W/m <sup>2</sup> K
Centre pane value	1.1W/m <sup>2</sup> K

U-values calculated in accordance with BS EN ISO 10077-1:2006.