

architectural BRONZE CASEMENTS

FITTING WITHOUT A REBATE

1. Confirm window location and position within the reveal. Check the structural opening size to the casement before removing the existing window.
2. Offer the window into the opening, locating packers at the screw fixing points to achieve an even perimeter gap. Ensure the frame is plumb & square, mark for drilling of fixings.
3. If fitting to stone and a primer is required, mark the perimeter faces of the window onto the reveal. See sheet "BR-IS17 Stone Reveals And Adhesion Testing" as a guide for the application of stone primer.
4. If fitting into stone, remove the window and drill for fixings, fit 7mm plugs into stone. We do not recommend the use of hammer action drills. Ensure all surfaces and screw holes are free of dust and debris.

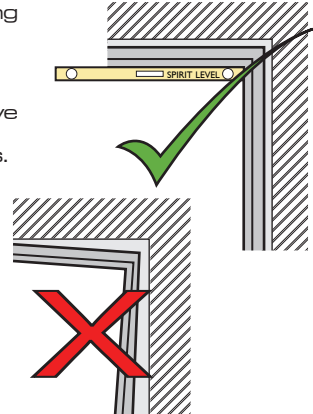

OR

5. If fitting into timber pre-drill timber for screws. Ensure all surfaces and screw holes are free of dust and debris.
6. Check all reveals have been prepared and apply primer if required.
7. Clean any bronze casement surfaces that will contact silicone, tapes and glass edges with IPA cleaner. Ensure wax is removed from these areas only and remains on the face of the casement. Read label on cleaner before use.
8. Fit the frame back using the packers as previously positioned to give an even perimeter gap. Packers should be set back from the face of the bronze to allow a continuous silicone perimeter seal to be applied.
9. Opening windows should be fixed at the hinge side first, do not force or over tighten screws or use incorrect sized packers to avoid distorting the frame. Template shaped windows should also have an even gap around the perimeter of the frame. Fill screws holes at the base of the frame with silicone to seal the screws when inserted.
10. Before fixing the remaining sides, check that the frame is set correctly and not twisted within the opening. For opening casements, insert sash packers and engage stays on pins, locate handles and locking grub screws correctly into the strike plate and adjust packers as required to ensure correct operation.
11. Glaze as per our glazing instructions - SEE SEPARATE SHEET
12. Insert backing rod as illustrated allowing a depth of 6mm for the sealant, mask off stone or timber surround. Apply bronze silicone perimeter seal and tool off.
13. Clean down frame and reapply wax coating once silicone is fully cured

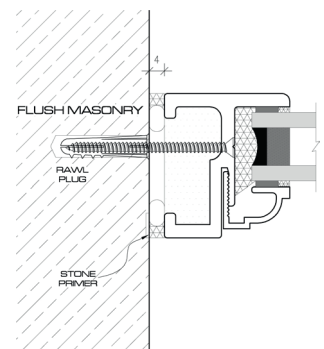
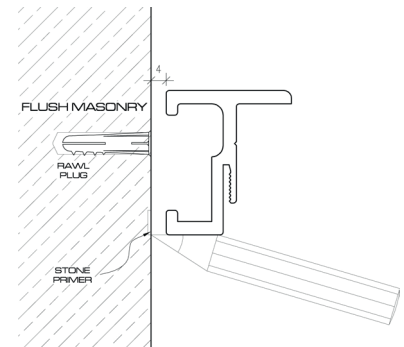

These guidelines are supplied as information only. Suitability of materials, tolerances and preparation methods suggested must be confirmed by the end user, client, installer or architect.